

Gallagher | IDEMIA

Biometric Access Solutions

The Gallagher and IDEMIA biometric integration offers a fast and secure way to ensure users are identified correctly. Users 'are' their credential - with Command Centre you can save time, increase security, and improve business process.



Integration benefits:

- Save expense with biometric enrollment and template management conducted directly through Gallagher Command Centre, eliminating the need for operators to purchase, train in and use two separate systems
- Save time on installation and configuration. Much of IDEMIA reader installation and configuration tasks have been automated and simplified
- Flexible and scalable. Reader options and adjustable licensing allow both large and small sites to make use of the biometric reader technology. Combinations of IDEMIA biometric and Gallagher card readers can easily be deployed.

Integration features:

- Accurate and effective. IDEMIA biometric recognition algorithms are rated highly by NIST (National Institute of Standards and Technology) - an independent institute of standards.
- Duress biometrics. For finger and Wave templates, if a duress biometric credential is presented at a reader, access is granted but an alarm is raised in Gallagher Command Centre
- Privacy options. The enrolled biometric template is encoded to a MIFARE® smartcard in one pass, never stored in permanent PC memory. This gives the enrolled user full control of their biometric template, providing peace of mind regarding privacy issues.

How the solution works

The high level integration between Gallagher and IDEMIA covers the two primary aspects of biometric authentication, identification and verification:

Identification - Biometric only

Identification is suited for customers wanting cardless access to areas of their site. Identification compares a person's finger, Wave or face biometric template to a database of stored templates, typically stored on the reader, and identifies the person from this database.

This is also commonly referred to as a '1 to many' or '1 to n' comparison. An employee presents their finger or face at the reader, which checks the reader database for a match. If the reader finds a match, it sends through the employee's ID to the Gallagher Controller for an access control decision.

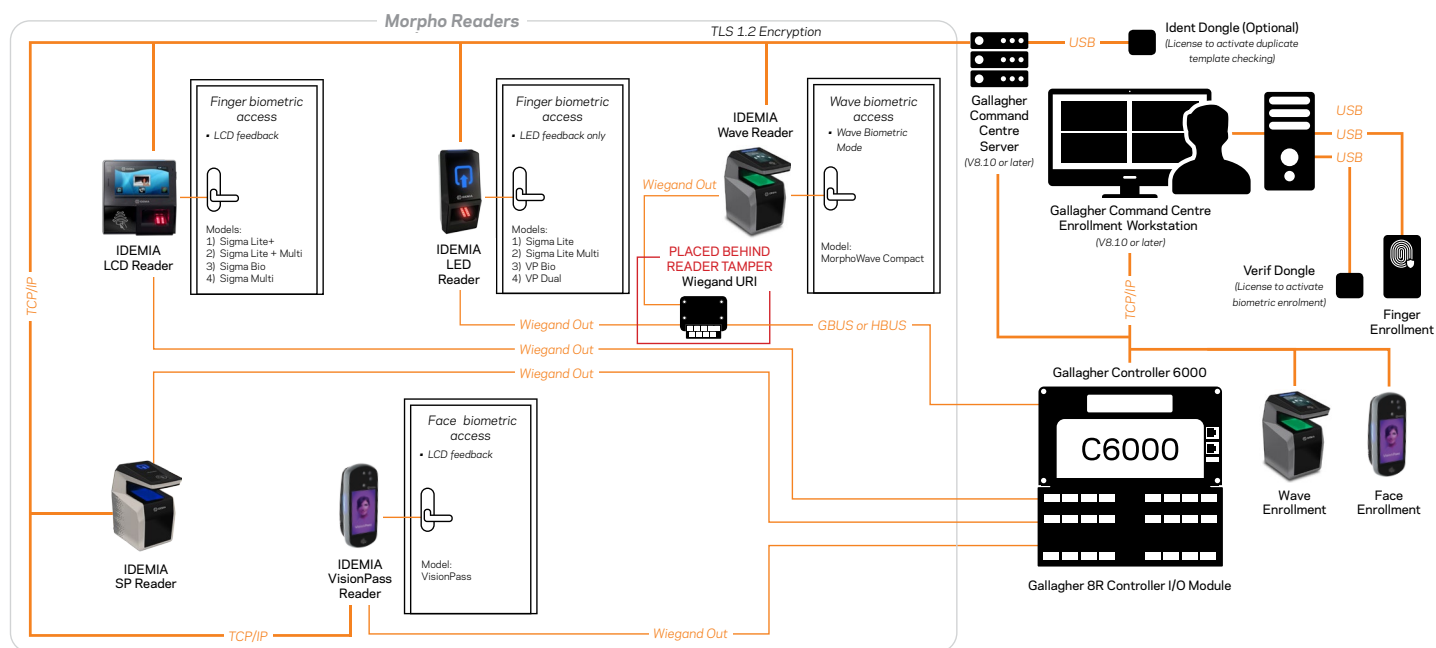

Verification - Card + Biometric + PIN

Verification is suited for customers wanting the high security of multi-factor authentication options (card + biometric + PIN).

Verification compares a person's biometric against a single biometric template, stored on the card. This is commonly referred to as a '1 to 1' comparison. Employees present their card to the reader, and then present their biometric template. The reader checks if the presented biometric matches the template stored on the card. If the reader finds a match, it sends through the employee's ID to the Gallagher Controller for an access control decision.

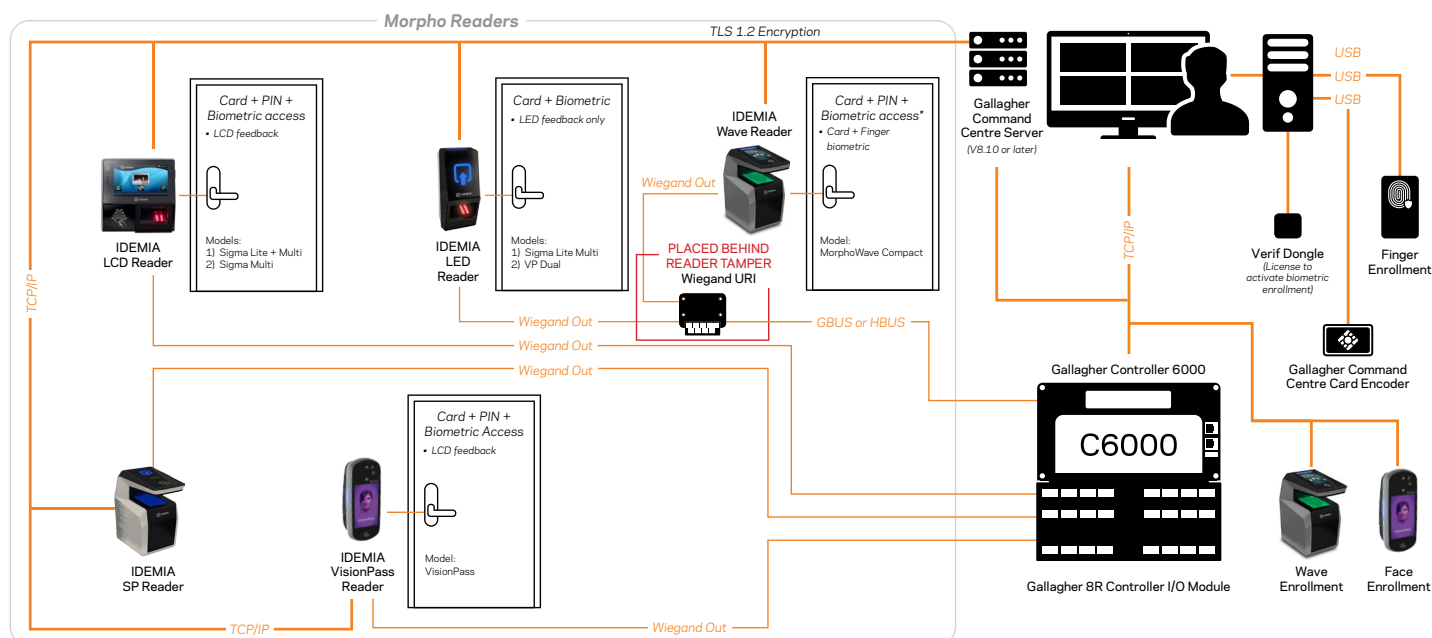

Secure template management

Encryption dongle requirements

Authentication Mode	CCFT Server	CC Enrol Workstation	Reader license DB
1:n Identification	Verif Dongle*	Verif Dongle	Sized to suit user count through door
1:n Identification (with duplicate template check)	Ident Dongle	Verif Dongle	Sized to suit user count through door
1:1 Verification	Verif Dongle*	Verif Dongle	N/A (template stored on card)

* From Command Centre v7.80 or later:
1. Maci license is not required on the server
2. Verif dongle is not required on the server unless it is used to enroll biometric templates

IDEMIA product reference

Features & compatibility	Model Range									
	SIGMA Lite	SIGMA Lite Multi	SIGMA Lite +	SIGMA Lite + Multi	SIGMA Multi	SIGMA Extreme Multi	MorphoWave SP*	MorphoWave XP*	VisionPass	MSO 330 Enrollment Reader
Finger template	✓	✓	✓	✓	✓	✓	✓	✓		✓
Wave template							✓	✓		
Face template									✓	
PIN				✓	✓	✓		✓	✓	
Card		✓		✓	✓	✓	✓	✓	✓	
LED confirmation	✓	✓					✓			
LCD Screen			✓	✓	✓	✓		✓	✓	
Default User DB	500	500	500	500	5000	5000	10000	40000	20000	n/a
Expansion User DB	3 & 10k	3 & 10k	3 & 10k	3 & 10k	10,50 & 100k	10,50 & 100k	n/a	100k	40k	n/a
Card Types	n/a	MIFARE Classic, DESFire EV1, EV2, and EV3	n/a	MIFARE Classic, DESFire EV1, EV2, and EV3	MIFARE Classic, DESFire EV1, EV2, and EV3	MIFARE Classic, DESFire EV1, EV2, and EV3	MIFARE Classic, DESFire EV1, EV2, and EV3	MIFARE Classic, DESFire EV1, EV2, and EV3	MIFARE Classic, DESFire EV1, EV2, and EV3	n/a
Bio Read Rate	1.0s	1.0s	1.0s	1.0s	1.0s	1.0s	1.0s	1.0s	0.5s	0.7s
Ingress	IP65	IP65	IP65	IP65	IP65	IP65	IP65	IP65	IP65	indoor
Impact	IK08	IK08	IK08	IK08	-	IK09	-	-	-	-

*MorphoWave and VisionPass devices are also installed at enrollment workstations for contactless biometric enrollment.

Supported products

A wide range of IDEMIA products can integrate easily with the Gallagher solution - a selection of currently supported products are displayed below. For more detail, please contact your nearest Gallagher representative.



SIGMA Lite Multi



SIGMA Lite + Multi



SIGMA Extreme Multi



SIGMA Multi



Verif Dongle 2



MSO 330 Enrollment Reader



MorphoWave SP



MorphoWave XP



VisionPass

Gallagher World Headquarters

181 Kahikatea Drive, Melville, Hamilton 3204
New Zealand

Phone +64 7 838 9800

Email security@gallagher.com



Regional Offices

Americas

Asia

Australia

India

Middle East

South Africa

United Kingdom / Europe

+1 877 560 6308

+852 2946 9641

+61 3 9308 7722

+91 98 458 92920

+971 4 566 5834

+27 11 974 4740

+44 2476 64 1234

Disclaimer

Please note that information contained in this document is intended for general information only. While every effort has been taken to ensure accuracy as at the date of the document, there may be errors or inaccuracies and specific details may be subject to change without notice. Copyright © Gallagher Group Limited.

3E0850 - 06/23