

# Gallagher | IDEMIA

## Biometric Access Solutions

The Gallagher and IDEMIA biometric integration offers a fast and secure way to ensure users are identified correctly. Users 'are' their credential - with Command Centre you can save time, increase security, and improve business process.

### Integration benefits:

- Save expense with fingerprint enrollment and template management conducted directly through Gallagher Command Centre, eliminating the need for operators to purchase, train in and use two separate systems
- Save time on installation and configuration. Much of IDEMIA reader installation and configuration tasks have been automated and simplified
- Flexible and scalable. Reader options and adjustable licensing allow both large and small sites to make use of the fingerprint reader technology. Combinations of IDEMIA biometric and Gallagher card readers can easily be deployed.

### Integration features:

- Accurate and effective. IDEMIA fingerprint recognition algorithms are No.1 rated highly in independent testing of fingerprint reader accuracy\*
- Duress biometrics. If a duress biometric credential is presented at a reader, access is granted but an alarm is raised in Gallagher Command Centre
- Privacy Options. The enrolled fingerprint template is encoded to a MIFARE® smartcard in one pass, never stored in permanent PC memory. This gives the enrolled user full control of their fingerprint template, providing peace of mind regarding privacy issues
- Visitors' biometrics can be captured upon enrollment for use with biometric readers across a site.

\*NIST 2012 Evaluation of latest fingerprint technologies:  
Extended features sets evaluation No.2.



## How the solution works

The high level integration between Gallagher and IDEMIA covers the two primary aspects of biometric authentication, identification and verification:

### Identification - Biometric only

Identification is suited for customers wanting cardless access to areas of their site. Identification compares a person's finger or Wave biometric template to a database of stored templates, typically stored on the fingerprint reader, and identifies the person from this database.

This is also commonly referred to as a '1 to many' or '1 to n' comparison. An employee presents their finger at the reader, which checks the reader database for a matching fingerprint. If the reader finds a match, it sends through the employee's ID to the Gallagher Controller for an access control decision.

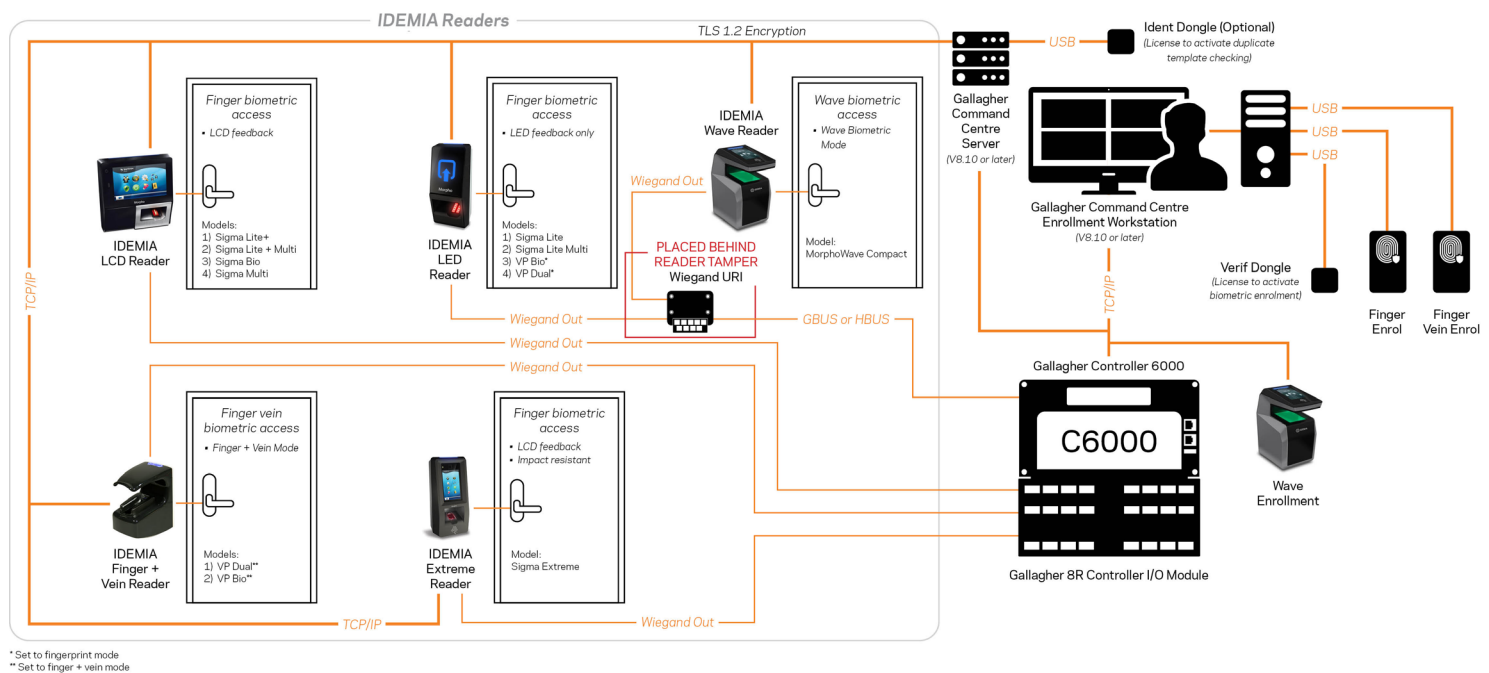

### Verification - Card + Biometric + PIN

Verification is suited for customers wanting the high security of multi-factor authentication options (card + biometric + PIN).

Verification compares a person's fingerprint against a single fingerprint template, stored on the card. This is commonly referred to as a '1 to 1' comparison. Employees present their card to the reader, and then present their fingerprint. The reader checks if the presented fingerprint matches the fingerprint template stored on the card. If the reader finds a match, it sends through the employees ID to the Gallagher Controller for an access control decision.

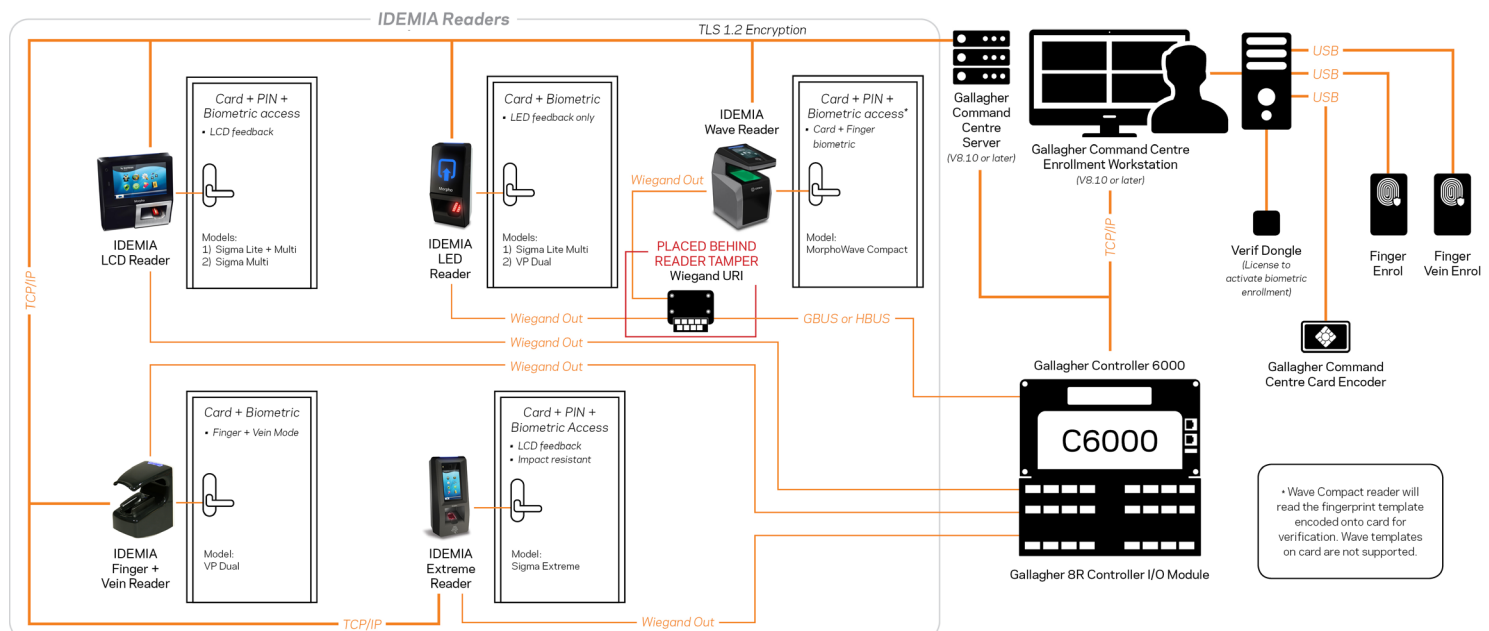

# Secure template management

## Encryption dongle requirements

Authentication Mode	CCFT Server	CC Enrol Workstation	Reader license DB
1:n Identification	Verif Dongle*	Verif Dongle	Sized to suit user count through door
1:n Identification (with duplicate template check)	Ident Dongle	Verif Dongle	Sized to suit user count through door
1:1 Verification	Verif Dongle*	Verif Dongle	N/A (template stored on card)

\* From Command Centre v7.80 or later:  
1. Maci license is not required on the server  
2. Verif dongle is not required on the server unless it is used to enroll biometric templates

## IDEMIA product reference

Features & compatibility	Model Range										
	SIGMA Lite	SIGMA Lite Multi	SIGMA Lite +	SIGMA Lite + Multi	SIGMA BIO	SIGMA Multi	VP BIO	SIGMA Extreme Multi	Wave Compact*	MSO 300 Enrolment Reader	MSO FVP Enrolment Reader
Finger	✓	✓	✓	✓	✓	✓	✓	✓	✓	✓	✓
Wave template									✓		
Finger vein							✓				✓
PIN				✓		✓		✓	✓		
Card		✓		✓		✓		✓	✓		
LED confirmation	✓	✓					✓				
LCD Screen			✓	✓	✓	✓		✓	✓		
Default User DB	500	500	500	500	5000	5000	5000	5000	20000	n/a	n/a
Expansion User DB	3 & 10k	3 & 10k	3 & 10k	3 & 10k	10,50 & 100k	10,50 & 100k	10k	10,50 & 100k	40k	n/a	n/a
Card Types	n/a	Classic, DESFire EV1, DESFire EV2	n/a	Classic, DESFire EV1, DESFire EV2	n/a	Classic, DESFire EV1, DESFire EV2	n/a	Classic, DESFire EV1, DESFire EV2	Classic, DESFire EV1, DESFire EV2	n/a	n/a
Bio Read Rate	1.0s	1.0s	1.0s	1.0s	1.0s	1.0s	1.0s	1.0s	44/min	0.7s	1.0s
Ingress	IP65	IP65	IP65	IP65	IP65	IP65	IP65	IP65	IP65	indoor	indoor
Impact	IK08	IK08	IK08	IK08	-	-	-	IK09	-	-	-

\*Wave Compact is also installed at enrollment workstation for Wave biometrics enrollment.

## Supported products

A wide range of IDEMIA products can integrate easily with the Gallagher solution, a selection of currently supported products are displayed below. For more detail, please contact your nearest Gallagher representative.



SIGMA Lite Multi



SIGMA Lite + Multi



SIGMA Extreme Multi



SIGMA Multi



VP Dual Finger Vein



MSO 300 Enrollment Reader



MSO FVP  
Finger Vein Enrollment Reader



Wave Compact



Verif Dongle

### GALLAGHER WORLD HEADQUARTERS

Kahikatea Drive, Hamilton 3206  
Private Bag 3026, Hamilton 3240  
New Zealand

TEL: +64 7 838 9800  
EMAIL: security@gallagher.com



### REGIONAL OFFICES

New Zealand.....+64 7 838 9800  
Americas.....+1 877 560 6308  
Asia .....+852 3468 5175  
Australia .....+61 3 9308 7722  
India .....+91 98 458 92920  
Middle East.....+971 4 5665834  
South Africa .....+27 11 974 4740  
United Kingdom / Europe.....+44 2476 64 1234

**DISCLAIMER:** This document gives certain information about products and/or services provided by Gallagher Group Limited or its related companies (referred to as 'Gallagher Group'). The information is indicative only and is subject to change without notice meaning it may be out of date at any given time. Although every commercially reasonable effort has been taken to ensure the quality and accuracy of the information, Gallagher Group makes no representation as to its accuracy or completeness and it should not be relied on as such. To the extent permitted by law, all express or implied, or other representations or warranties in relation to the information are expressly excluded. Neither Gallagher Group nor any of its directors, employees or other representatives shall be responsible for any loss that you may incur, either directly or indirectly, arising from any use or decisions based on the information provided. Except where stated otherwise, the information is subject to copyright owned by Gallagher Group and you may not sell it without permission. Gallagher Group is the owner of all trademarks reproduced in this information. All trademarks which are not the property of Gallagher Group, are acknowledged. Copyright © Gallagher Group Ltd. All rights reserved.

3E0850 04/19